



## TEKNO CONCEALED HINGE DOOR - NOA

---

MIAMI DADE NOTICE OF ACCEPTANCE  
NOA No. 22-0711.02 Expires September/7/2027



Safety Door with Concealed Hinges characterized by high-end performance. It can be installed flush with internal wall, flush with external wall, flush with plasterboard wall, interior coplanar with surround.

Maximum Size External Frame 48"W x 98 7/8"H

- ✓ Flush with wall
- ✓ Covering with sector or a single panel
- ✓ Concealed hinges



wind



break-in



thermal



acoustic



air



water





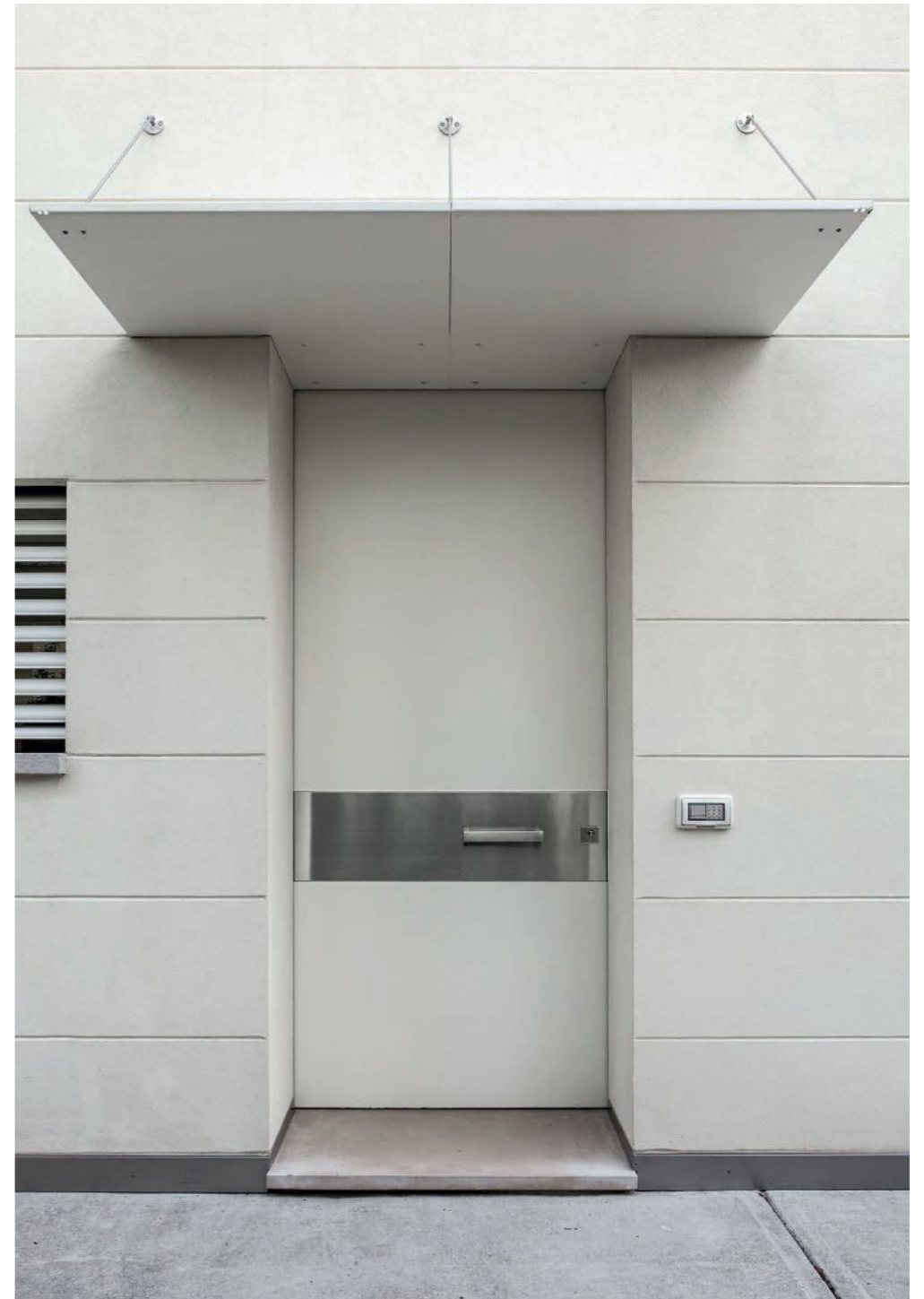



## SPECIAL FEATURES



### CONCEALED HINGES

The Tekno and Project lines, which allow a 100° opening of the door, feature an exclusive hinge, absolutely invisible when the door is closed. This is a valuable detail that allows designers to express a new sense of strength and essentiality, highlighting the line and finish.



### FINISHING ALUMINUM ELEMENTS

Endless customization. The Tekno door allows choosing the aluminum finishes for the frame and the leaf among three different colors.



### SECURITY CELL

The particular closed section of the frame allows creating a cell for containing the safety bolts and the hinge bolts that is impregnable to any attempt to force the door.



### FLUSH WITH THE WALL

The leaf flush with the wall allows a perfectly cleaned shape.



### OWNER'S KEYS

All Oikos doors are supplied with a building site key to be used for the production checks and by the technical staff entrusted with the installation, as well as with the owner's keys, sealed inside a special box.



### SQUARE MASK AND DEFENDER MASK

When required by door aesthetics, it is possible to opt for a square cover and cylinder cover, available in the following versions: polished brass, brushed chrome, polished chrome, and antique bronze.

## PANEL OPTIONS



Single Leaf



Single Leaf with over panel

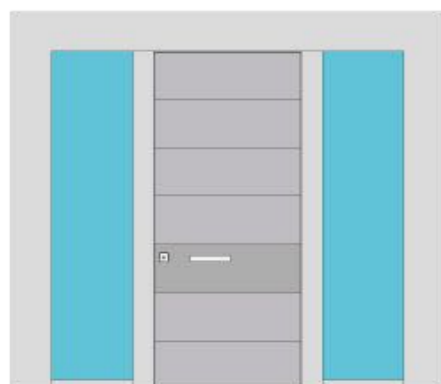

Leaf with 2 Sidelights

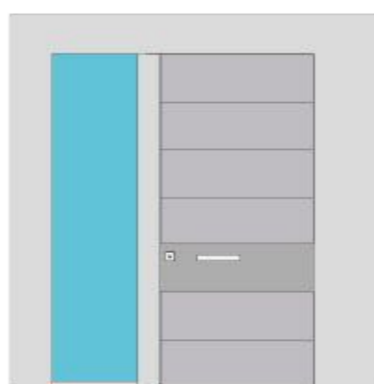

Leaf with Sidelights

FINISHES AVAILABLE:

WOOD, LACQUERS, GLASS, METAL, PORCELAIN AND MORE

\*Sidelights by others (See following pages for finishes)



### Long handle

The further enrich the door, it is possible to customize on the outer side by choosing the long handle made of steel. Installed vertically or horizontally.

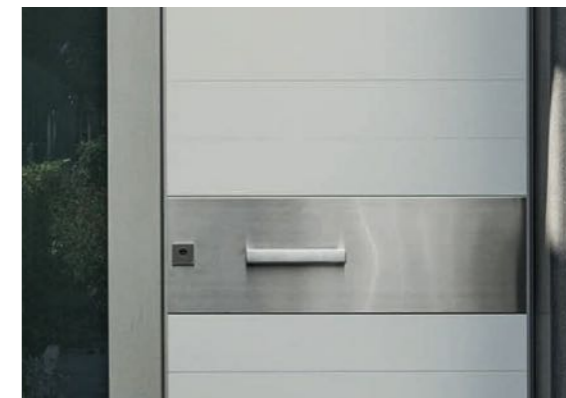

### Short handle

The external handle can be added in its short version, too. Installed vertically or horizontally.



### Recessed handle

In the version with recessed handle the opening from inside may also take place by the rotation of the original knob.



### Single action lever

An alternative to the recessed handle is the single action lever for the interior.

## ELECTRONIC LOCKING SYSTEM

Easy version: Battery operated, no on-site wiring work needs to be carried out.

Full version: Preset for connection to the low voltage mains supply and is compatible with all opening systems because it can be used even without any pre-arranged electrical system.

Smart because it can be operated using transponder key, keypad, and radio control.

Secure because locking of the door takes place automatically just by its being pulled to.

Convenient because it is possible to control several entrances with a single radio control: gate, up-and-over door, door.

Generous because it can be connected to a burglar alarm system or to the domotic control for a smart house management.

### OPENING FROM OUTSIDE



▪ With transponder



▪ with radio control



▪ with keypad

### OPENING FROM INSIDE



▪ with button



▪ with mechanical key



▪ with remote control

## ELECTRONIC LOCK OPTIONS



### Arckey

An access control system, integrated in safety doors, managed through the Tech App for smartphones, and equipped with an electronic opening system.



### PIN Keypad

The leaf opening can take place by storing a PIN code on a dedicated numeric keypad.



### Power Supply Transformer

\*Required for home automation control



### Card

The Security Code System consists of three cards subject to progressive deactivation that allow the administrator to always have the control of the secret code for accessing the Oikos Tech App programming.



### Finger Print Reader

Use this option for quick access using your fingerprints. The fingerprint reader is harmoniously inserted in the door and coordinated with the accessories already installed.



### Smart Home Control Sensor

\*Required for home automation control

# TECHNICAL DETAILS

Max. Dimensions

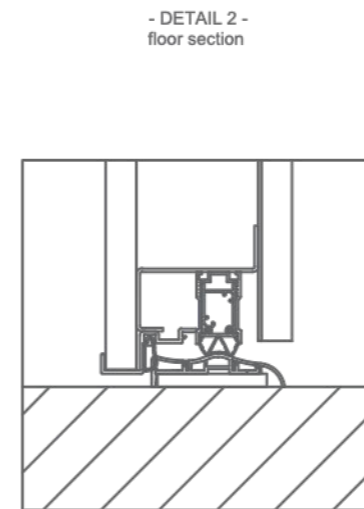
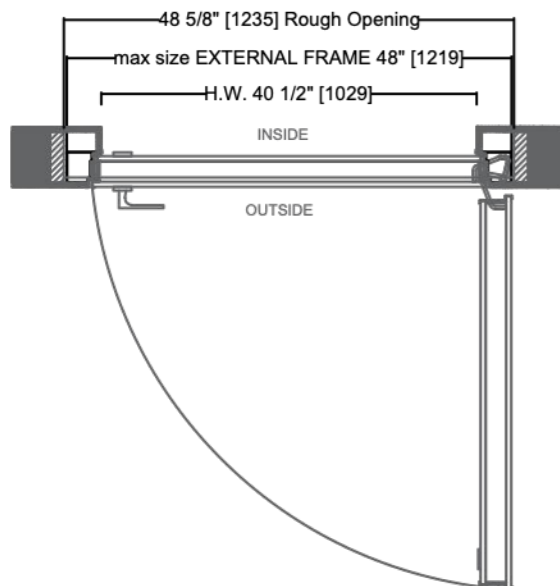
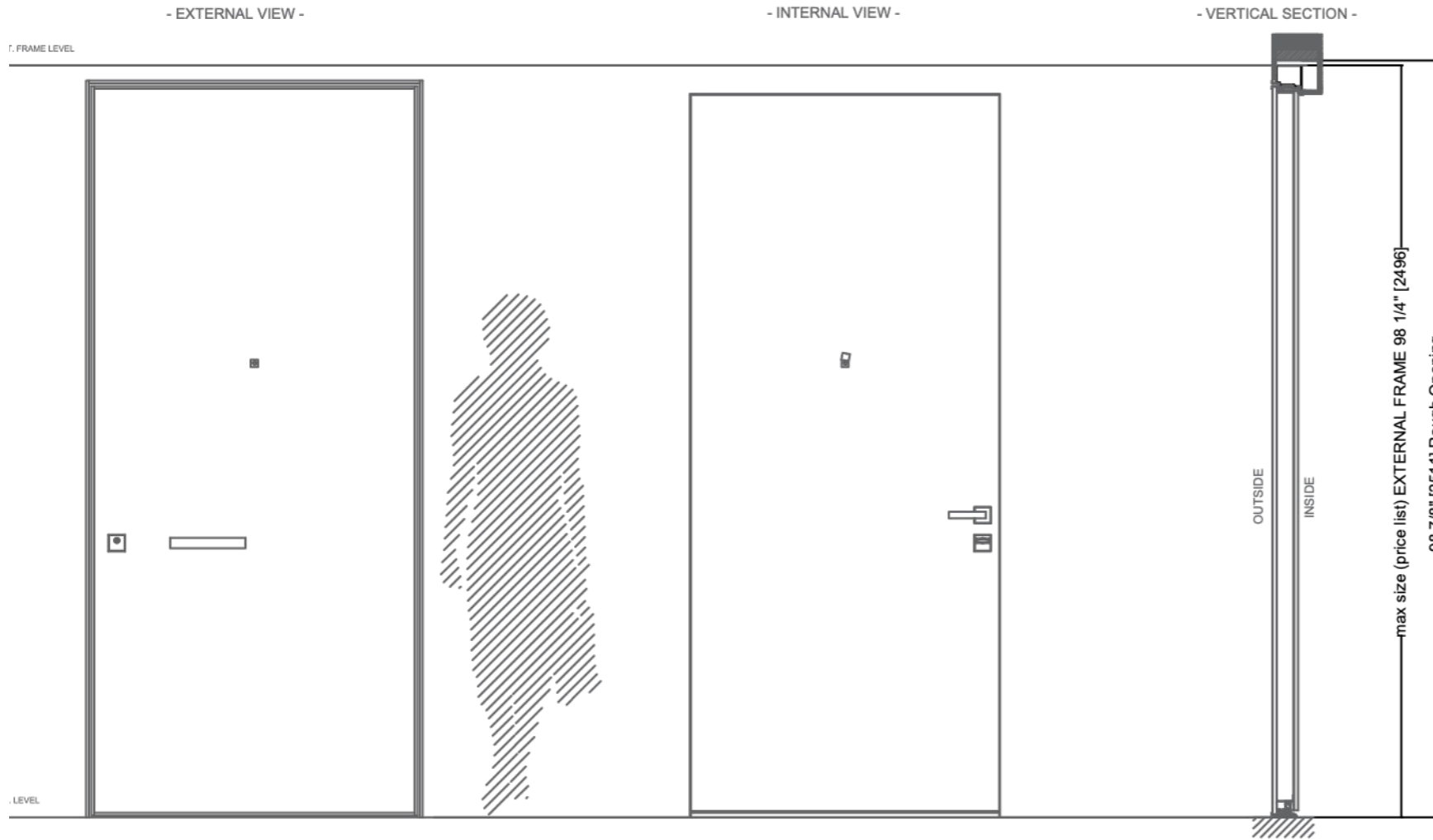

Exterior Concealed Hinged Door  
Out-Swing only  
Maximum Size External Frame  
48"W x 98 7/8"H

\*Peephole available on request

# INSTALLATION TYPES

# INSTALLATION OPTIONS

Flush on Exterior

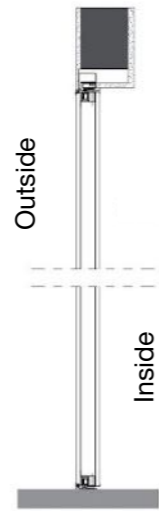
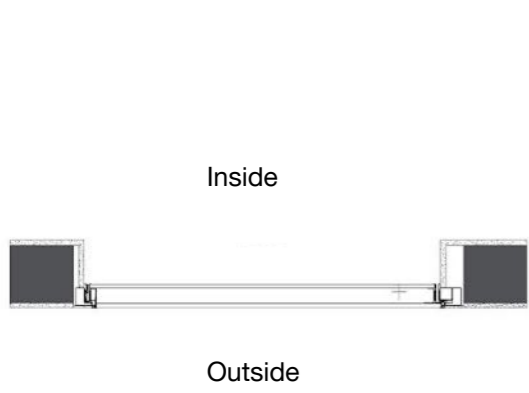

Flush on Interior

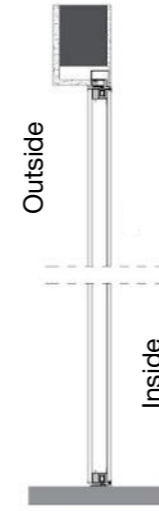
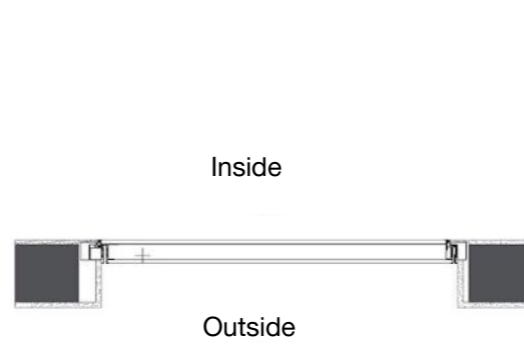

Centered on wall thickness

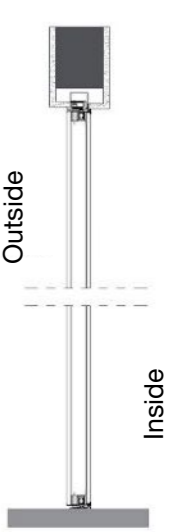
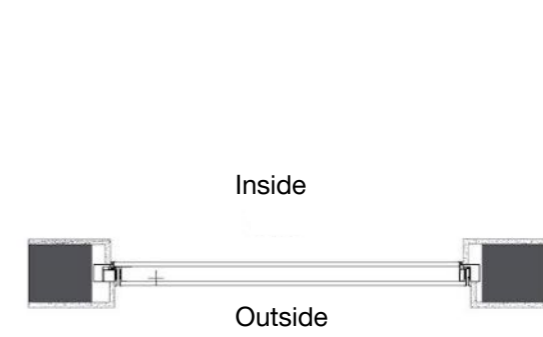

## SWING DIAGRAMS (Out Swing Only)

Pull Right

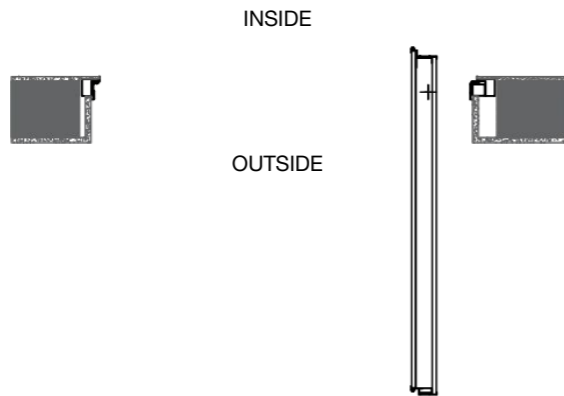

Pull Left

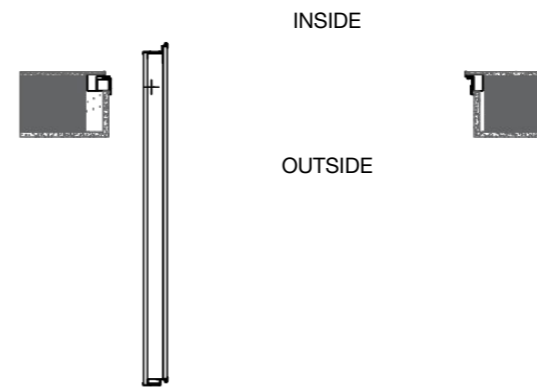

SOLID

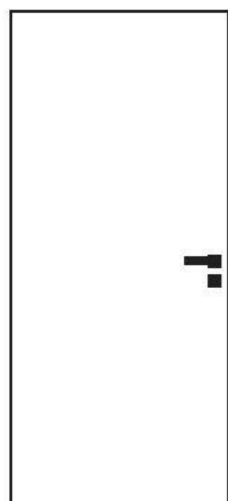

SOLID WITH INSERT

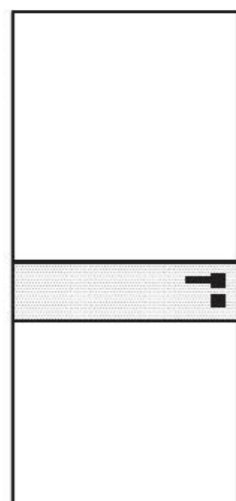

HORIZONTAL SECTORS

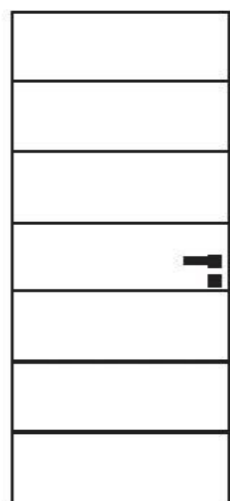

HORIZONTAL SECTORS WITH INSERT

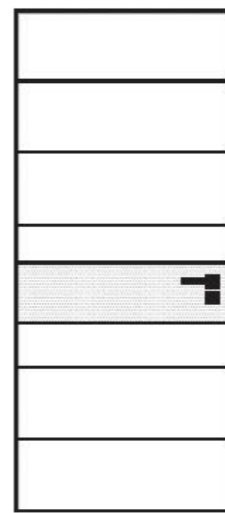

VERTICAL SECTORS

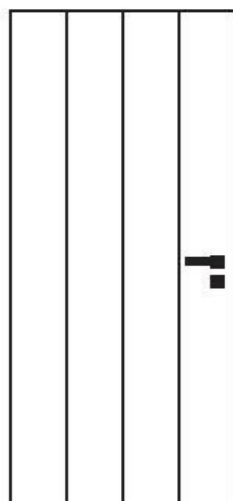

VERTICAL SECTORS WITH CUSTOM INSERT

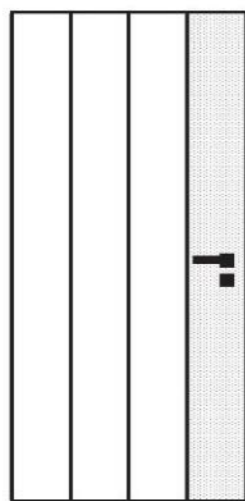

CUSTOM  
\*Please Indicate Layout

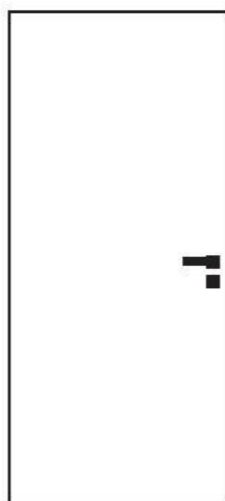

Finish materials:  
Wood, lacquers, glass, metal, porcelain and others  
(See finishes pages)

OPTIONAL: Paneling material is available for interior and exterior installation.

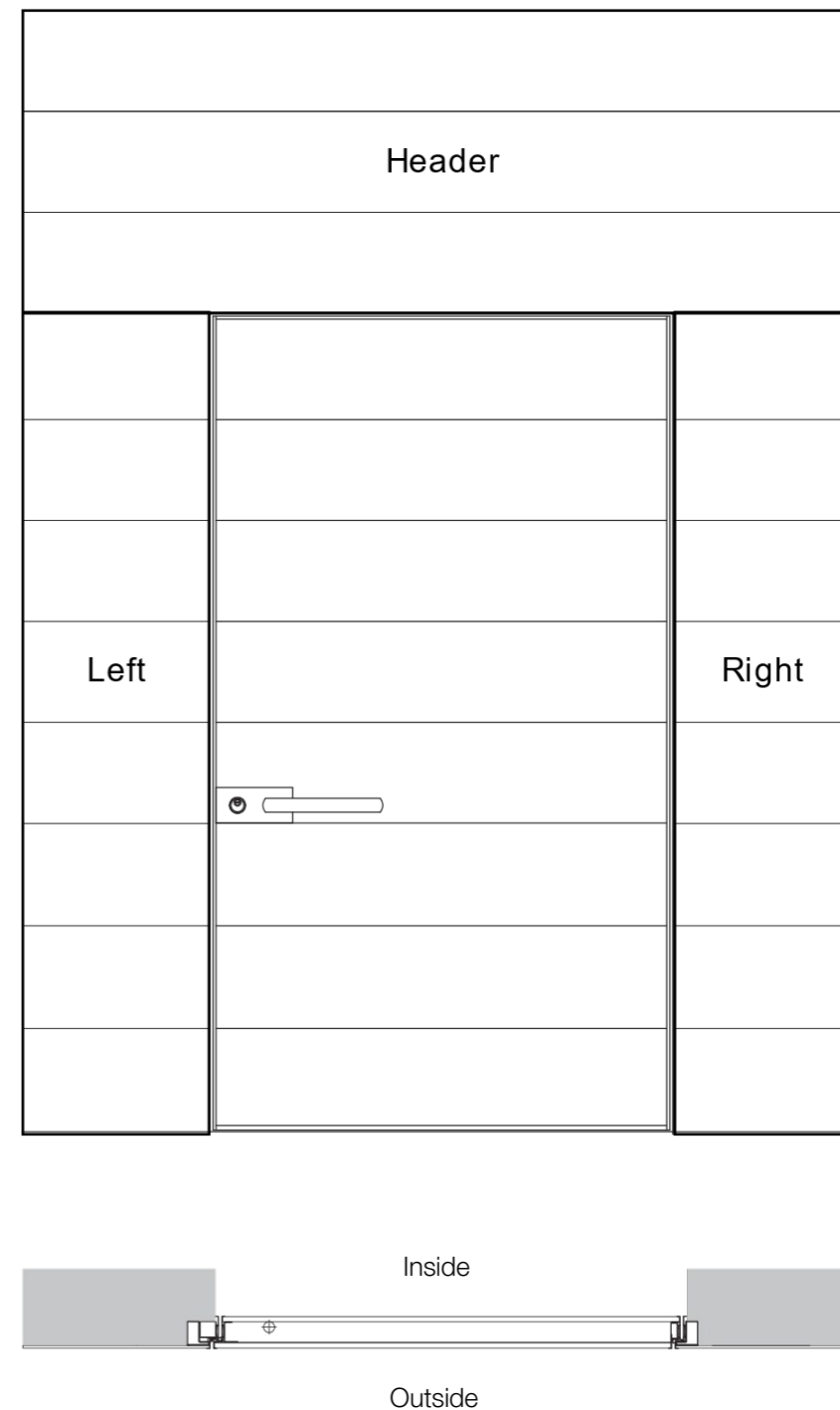

Impact resistant - NOA approval- Hurricane proof and 120min UL fire rated.

Paneling material is available for interior and exterior installation.

Line Tekno

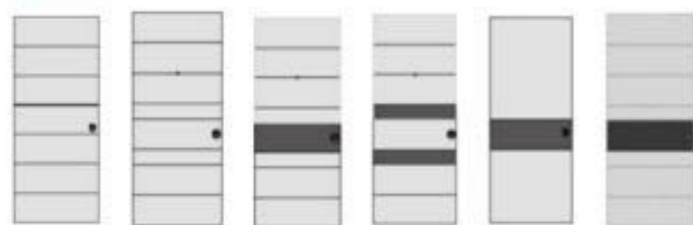

Line Carved

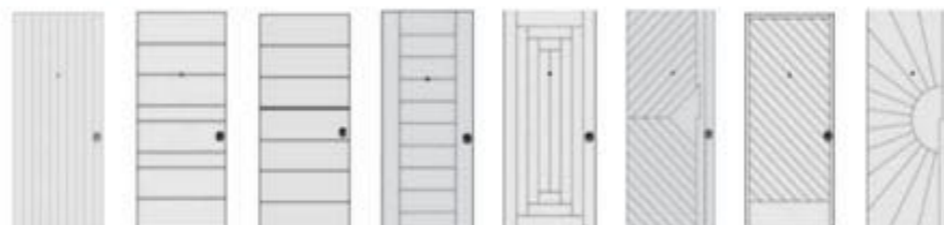

Line Smooth

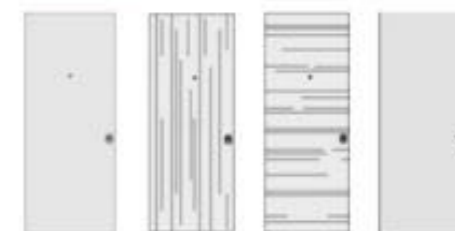

Line Pantographed



Line Legno Vivo



Line Heartwood



Line Bugnato



FINISH MATERIALS:

WOOD, LACQUERS, GLASS, METAL, PORCELAIN AND OTHERS (See finishes on next pages)

EXTERNAL WOODS/LEGNI ESTERNI



Okoumè 6



Okoumè 7



Okoumè 8



Okoumè Laccato 3003  
Okoumè Lacquered 3003



Okoumè Laccato 9002  
Okoumè Lacquered 9002/ANY RAL



Okoumè Mogano  
Okoumè Mahogany

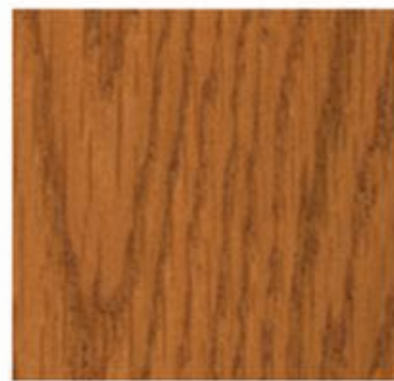

Rovere Miele  
Honey Oak



Rovere 2  
Oak 2



Rovere  
Oak 3



Quercia Antica  
Antique Finished Oak

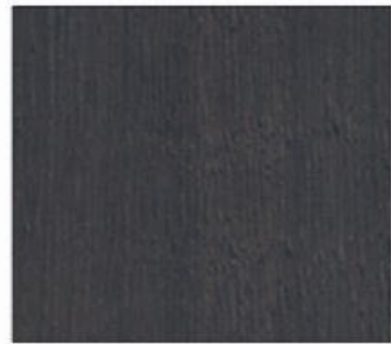

Grigio Piombo  
Lead Grey

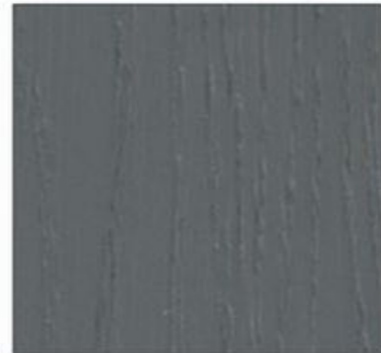

Grigio Agata  
Agata Grey



Tobacco



Rovere 1  
Oak 1

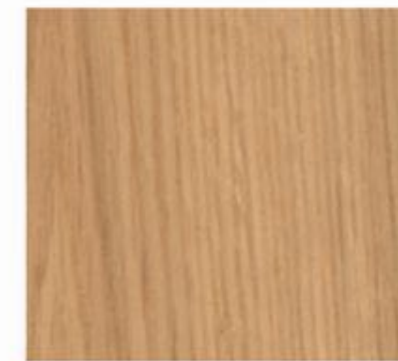

Rovere naturale 1  
Natural Oak 1



Mother-of-pearl  
Madreperla

- Less resistant to Florida Climate by half than rest of the materials

TRESPA [https://www.trespa.com/en\\_US/products/wood-decors](https://www.trespa.com/en_US/products/wood-decors)

Trespa® is a high-pressure compact laminated panel (HPL)



Italian Walnut Watt NW 08



Country Wood Satin NW 13



French Walnut Satin NW 14



Milano Terra Matt NW 16



Milano Grigio Matt NW 17



Light Mahogany Satin NW 18



Slate Wood Satin NW 22



Greyed Cedar Matt NW 24



Hesbania Matt NW 25



Core Ash Matt NW 26

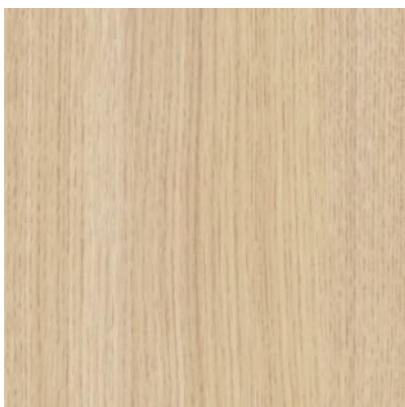

Denver Oak Matt NW 27



Halmstad Matt NW 28



Tropical Ipe Matt NW 30

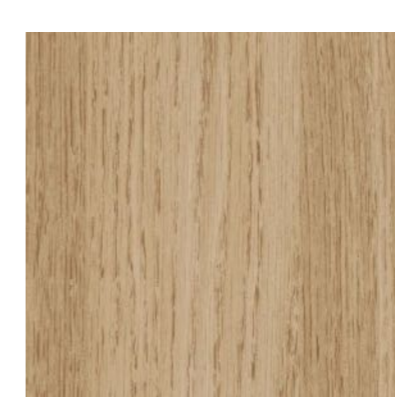

Elegant Oak NW 02 Matt/Satin

LAMINAM

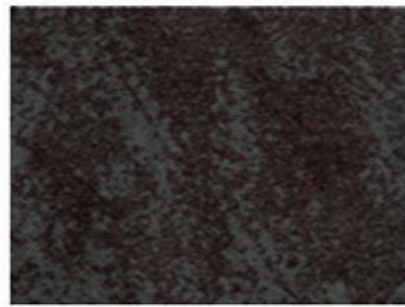

Cor-ten Acciaio  
Steel Cor-ten

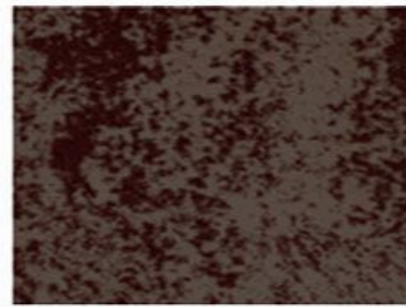

Cor-ten Ruggine  
Rust Cor-ten



Neve  
Snow



Nero Assoluto  
Black



Calce Grigio  
Gray Lime

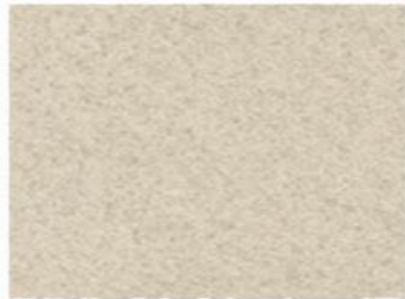

Calce Bianco  
White Lime

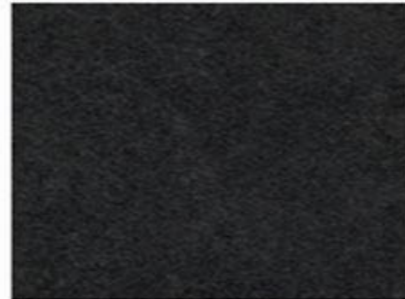

Ossido Nero  
Black Oxide



Calce Tortora  
Dove Grey Lime

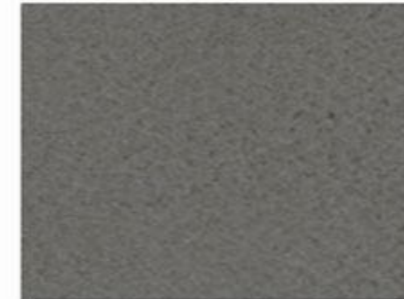

Calce Antracite  
Anthracite Lime

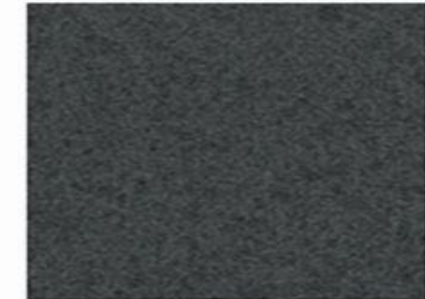

Calce Nero

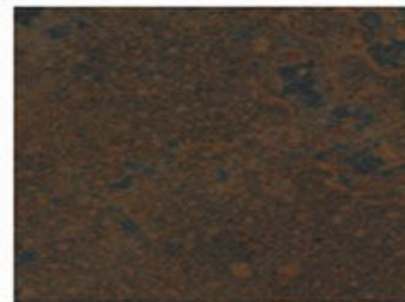

Ossido Bruno  
Brown Oxide

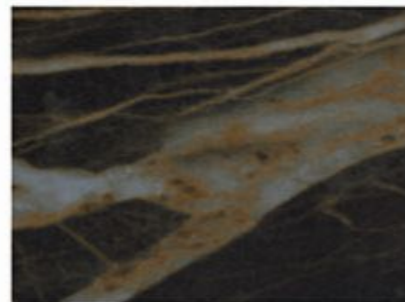

Ossido Desir Opaco  
Matt Noir Désir



Arabescato Statuario Lucido



Matt Statue White



Noir Decir Lucido  
Glossy Noir Desir



Natural "Piasentina" Stone

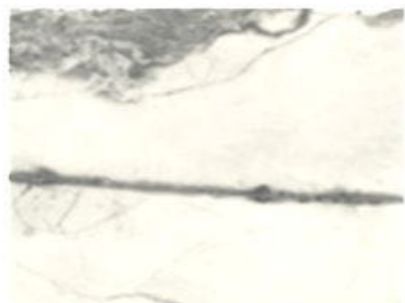

Invisible White Soft Touch



White Split Slate  
Ardesia Bianco a Spacco



Black Split Slate  
Ardesia Nero a Spacco

NATURAL STONE/PIETRA NATURALE



Arabescato Orobico Grigio



Fior di Bosco



Fusion Brown



Onice Ocean Blue



Invisible Grey



Sodalite Blue

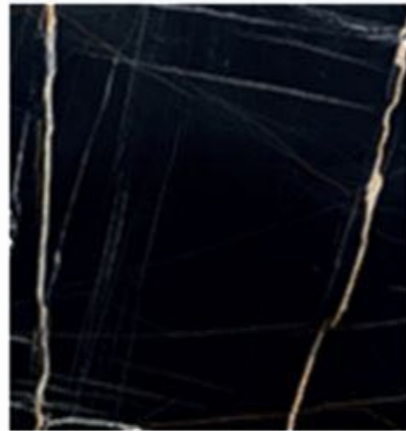

Sahara Noir



Onice Scorpione



Onice Ivory White



Onice Bianco Lucido

LACQUERED/LACCATI

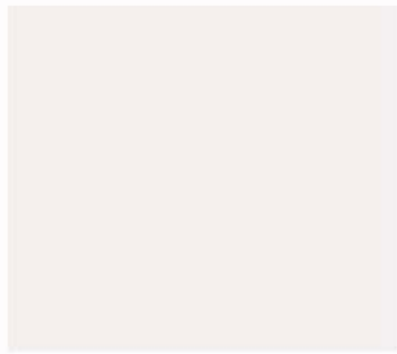

Bianco Seta  
Silk White

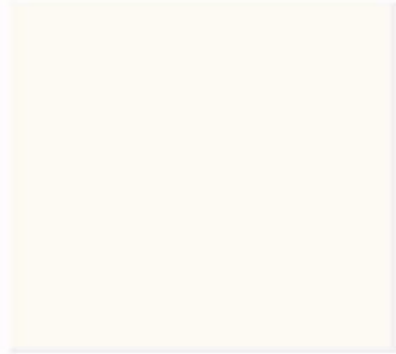

Bianco  
White

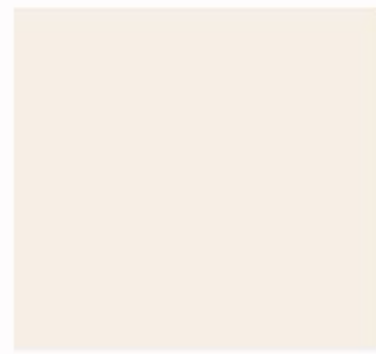

Bianco Guess  
Chalk White



Grigio Ghiaia  
Gravel Gray



Grigio Muschio  
Musk Gray



Bianco Panna  
Cream White



Moka

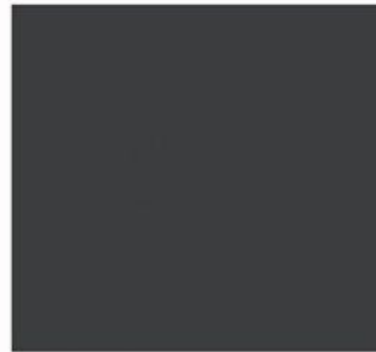

Grigio Piombo  
Lead Gray



Tabacco



Bronzo Chiaro  
Light Bronze

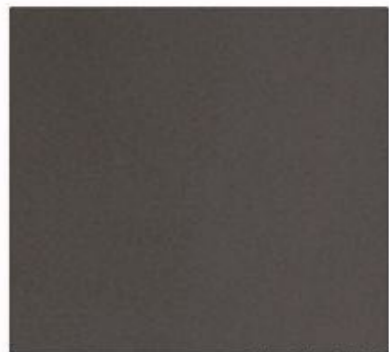

Bronzo Scuro  
Dark Bronze

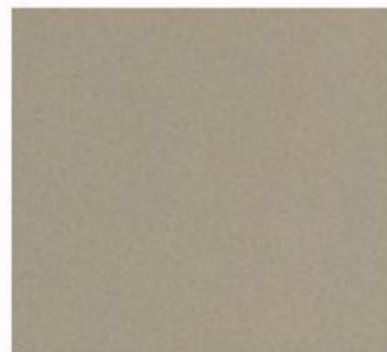

Platino  
Platinum

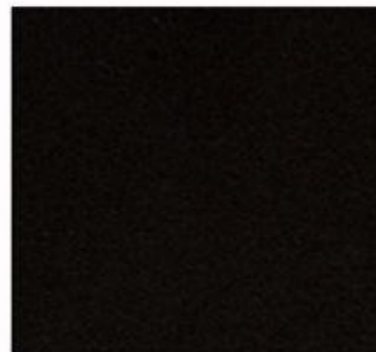

Fumo  
Smoke

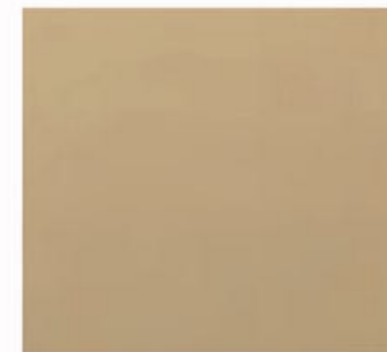

Oro  
Gold



Rame  
Copper

ALUMINUM/ALLUMINIO - FOR DOOR PANEL



FINISH MATERIAL

- **VP** - Powder Coating
- **VL** - Liquid Paining
- **OA** -Anodic Oxidation
- Available colors and finishes realized through a powder or liquid coating cycle, available for all metal door components.
- The marine Silver and Metropolitano finishes, being made by anodic oxidation can be realized only for aluminum components.

INTERNAL WOODS/LEGNI INTERNI



Noce Tanganica 1  
Walnut Tanganica 1



Noce Tanganica 2  
Walnut Tanganica 2



Noce Tanganica 3  
Walnut Tanganica 3

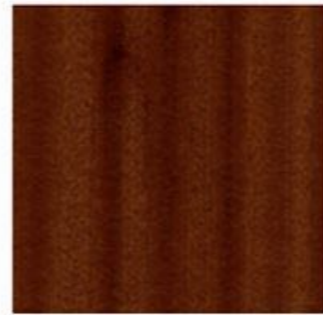

Mogano 2  
Mahogany 2



Mogano 3  
Mahogany 3

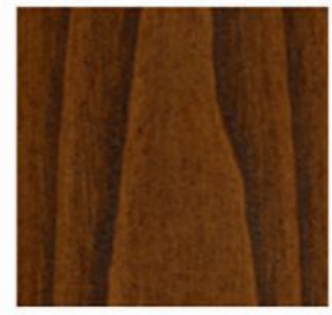

Chestnut 3  
Castagno 3

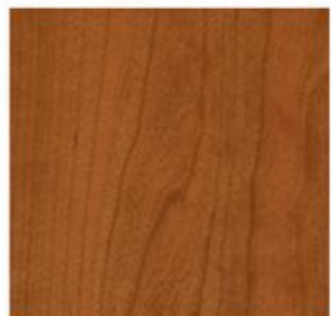

Ciliegio 1  
Cherry 1



Laccato Bianco Oikos  
Oikos White Lacquered



Noce Nazionale 2  
National Walnut 2



Teak

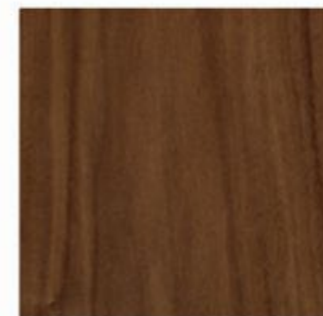

Noce Canaletto  
Canaletto Walnut



Douglas 2



Rovere 1  
Oak 1



Rovere naturale 1  
Natural Oak 1

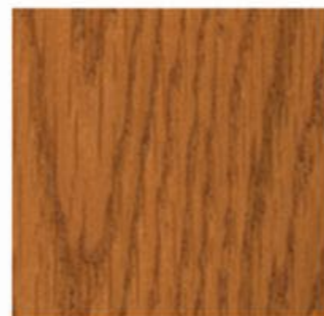

Rovere Miele  
Honey Oak 2



Rovere 2  
Oak 2



Rovere 3  
Oak 3



Pino 2  
Pine 2



Rovere Raw Moka  
Raw Mocha Oak



Rovere Raw Allie  
Raw Allier Oak

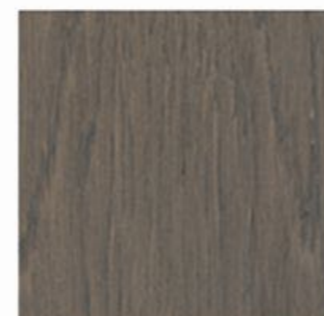

Rovere Raw Cenere  
Raw Ash Oak



Castagno 2  
Chestnut 2

LEGNO VIVO



Grigio Piombo  
Lead Grey



Chalk White  
Bianco Gesso



Mother-of-pearl  
Madreperla

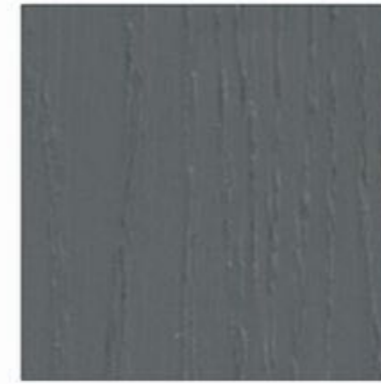

Grigio Agata  
Agate Gray

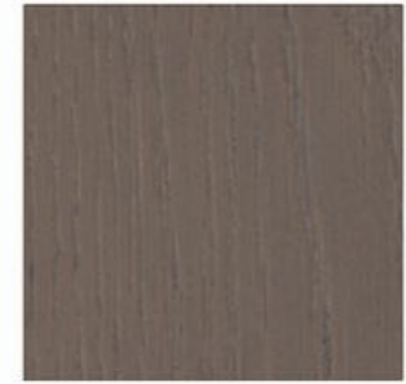

Tobacco



Quercia Antica  
Antique Finished Oak



Oak 1



Rovere Miele  
Honey Oak



Rovere 2  
Oak 2



Rovere  
Oak 3



Laccato Ral 9005  
RAL 9005 Lacquered



Rovere Naturale  
Natural Oak

OPEN PORE LACQUERED/LACCATI PORO APERTO



Bianco Gesso  
Chalk White



Bianco  
White



Bianco Panna  
Cream White



Grigio Muschio  
Musk Grey



Moka



Platinum  
Platino



Bronzo Scuro  
Dark Bronze



Fumo  
Smoke



Bronzo Chiaro  
Lead Grey

FASHION



Trespa Harmony Oak

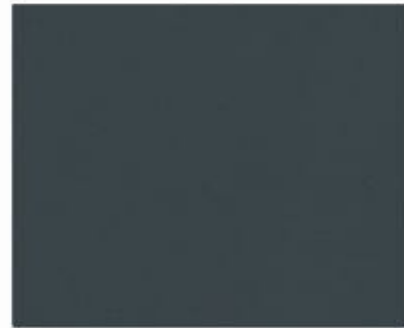

Trespa New York Grey



Ottone Antico  
Antique Brass



Ottone Brunito  
Burnished Brass



Rovere Vecchio 2  
Old Oak 2



Rovere Vecchio 3  
Old Oak 3



Abete Antico  
Antique Fir

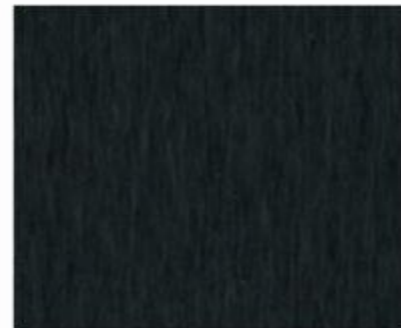

Steel Color Nero Satinato  
Steel Color Satin Black

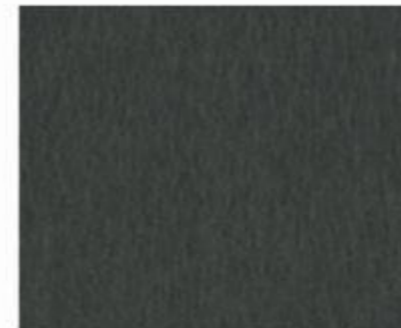

Steel Color Grigio Satinato  
Steel Color Satin Grey

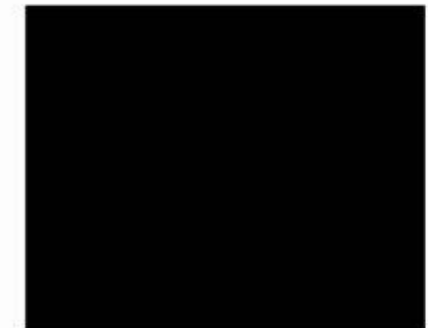

Laccato Nero 100 gloss  
Black Lacquered 100 gloss



Laccato Nero 50 gloss  
Black Lacquered 50 gloss



Laccato Nero 25 gloss  
Black Lacquered 25 gloss



Rovere 50 gloss  
Oak 50 gloss



Rovere 25 gloss  
Oak 25 gloss



Rovere 0 gloss  
Oak 0 gloss

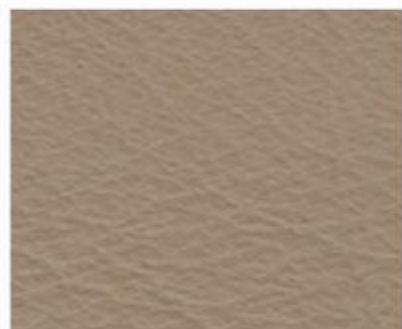

Pelle Beige  
Beige Leather

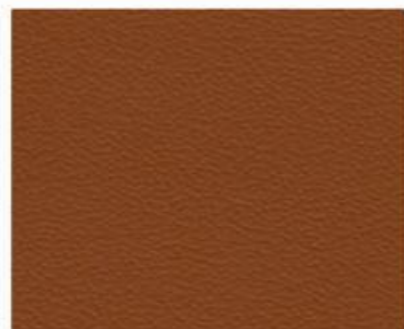

Cuoio Toscano  
Tuscan Leather



Pelle Rossa  
Red Leather



Onice Ivory White Lucido  
Glossy Onice Ivory White

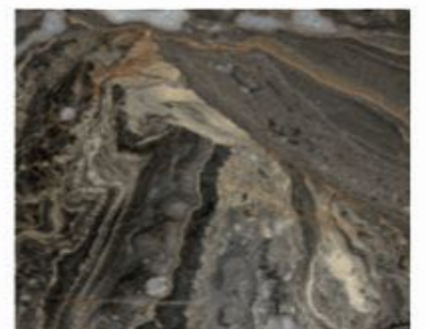

Arabescato Orobico  
Grigio Lucido/Glossy

MATERICI



Bianco Rovere Sablè  
White Oak Sablé



Grigio Rovere Sablè  
Gray Oak Sablé



Bianco Talco  
Talc White



Grigio Talco  
Talc Gray



Bianco Sablè  
White Sablé



Grigio Rovere Sablé  
Gray Sablé

MATT GLASS/VITRI OPACHI

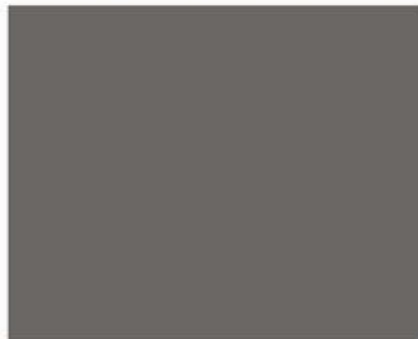

Grigio Muschino  
Musk Gray



Moka

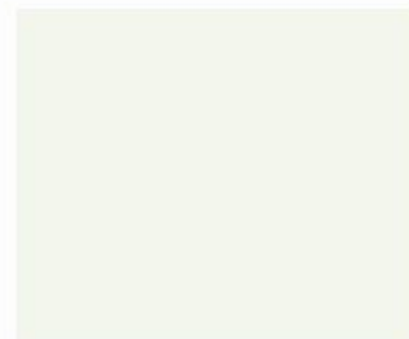

Bianco  
White



Bianco Gesso  
Chalk White



Bianco Panna  
Cream White

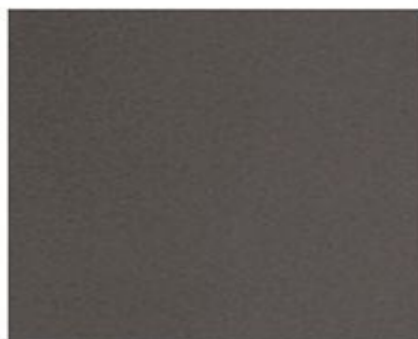

Bronzo Scuro  
Dark Bronze



Bronzo Chiaro  
Light Bronze

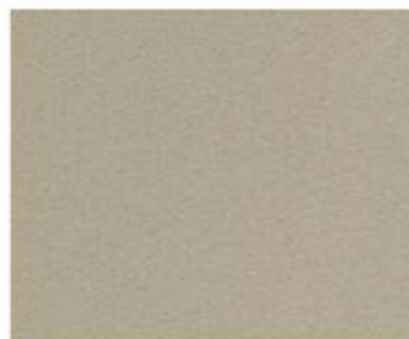

Platino  
Platinum

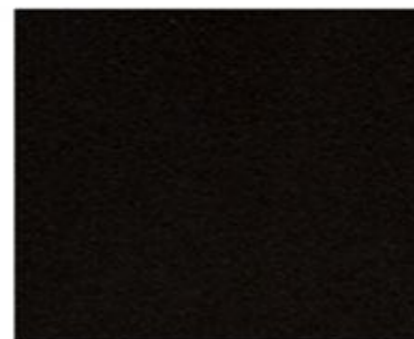

Fumo  
Smoke

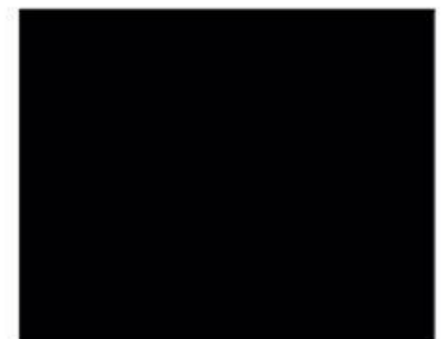

Nero  
Black

POLISHED GLASS/VETRI LUCIDI



Bianco Panna  
Cream White



Bianco  
White



Bianco Gesso  
Chalk White



Bianco Seta  
Silk White



Gravel Gray  
Grigio Ghiaia

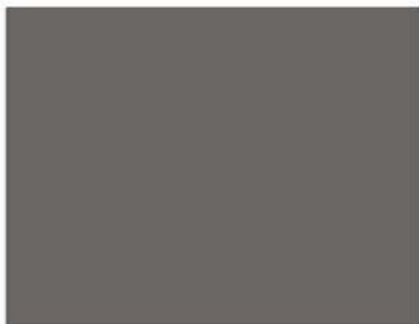

Grigio Muschio  
Musk Gray

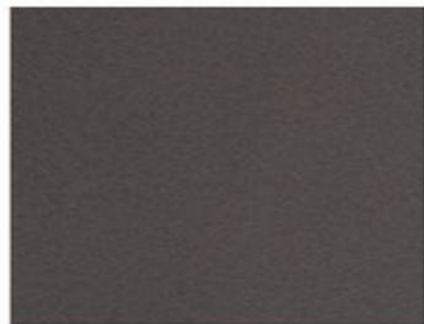

Bronzo Scuro  
Dark Bronze

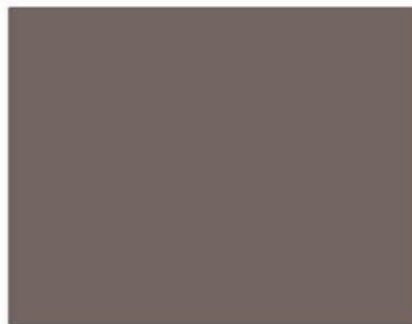

Tabacco

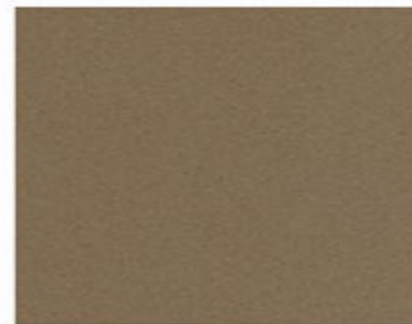

Bronzo Chiaro  
Light Bronze

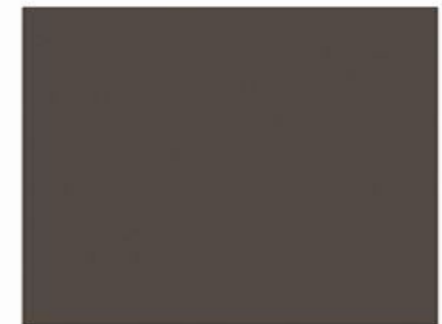

Moka



Grigio Piombo  
Lead Grey



Rame  
Copper



Oro  
Gold



Platino  
Platinum



Nero  
Black

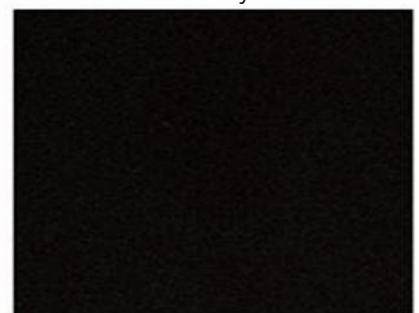

Fumo  
Smoke

METALLIC LACQUERED/LACCATI METALLIZZATI

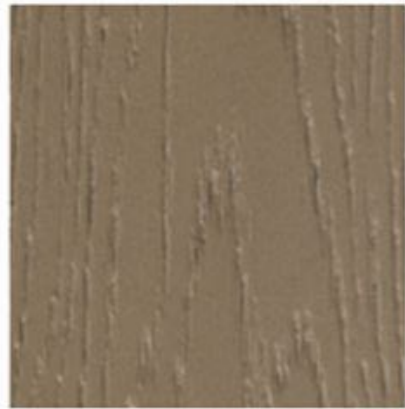

Bronzo Chiaro  
Light Bronze

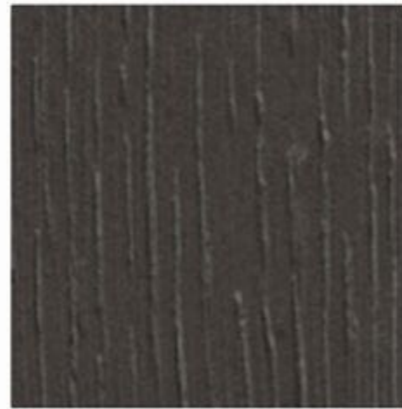

Bronzo Scuro  
Dark Bronze

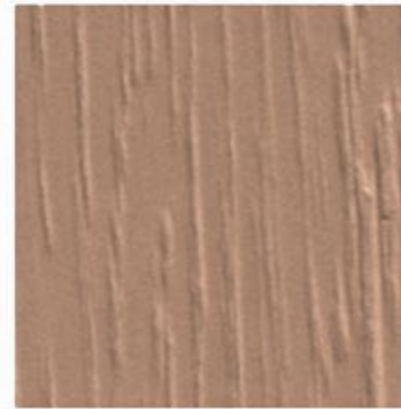

Rame  
Copper



Fumo  
Smoke

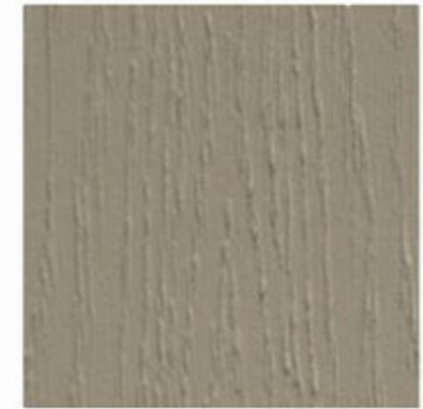

Platino  
Platinum



Oro  
Gold

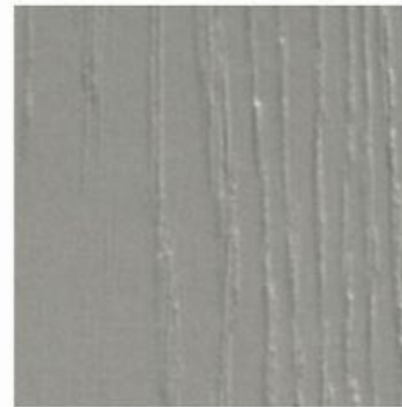

Argento Marino  
Sea Silver

ALUMINUM FOR FRAME AND HARDWARE



Oro Gold

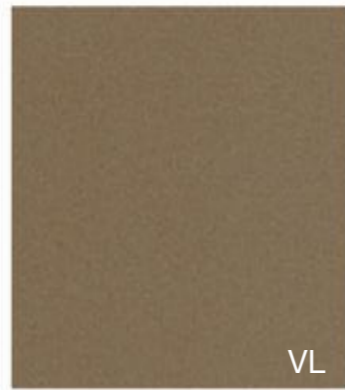

Bronzo Chiaro  
Light Bronze



Bronzo Scuro  
Dark Bronze

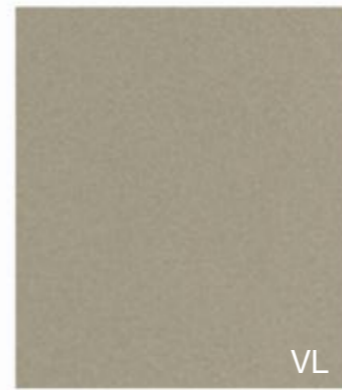

Platino  
Platinum



Metropolitano



RAL 9016

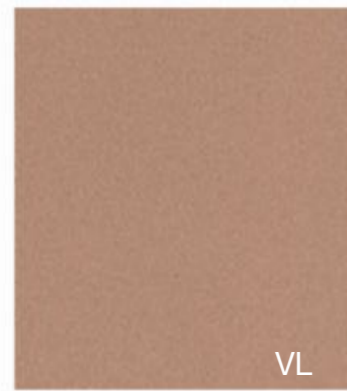

Rame  
Cooper



Argento Marino  
Marine Silver



Fumo  
Smoke



Cosmo



Sabbia  
Sand



Acciaio Alluminio Spazzolato  
Steel Brushed Aluminum

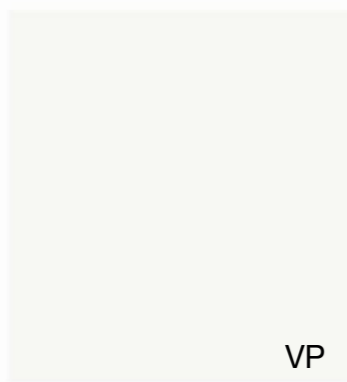

Ghiaccio/Ice

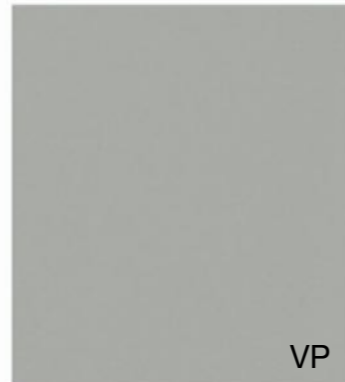

Ral 9006



Cor-ten

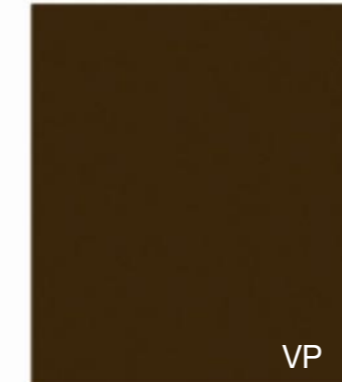

Ottone Brunito  
Burnished Brass

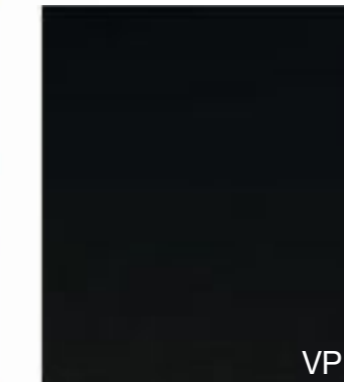

Ral 8022

FINISH MATERIAL

- **VP** - Powder Coating
- **VL** - Liquid Paining
- **OA** -Anodic Oxidation

- Available colors and finishes realized through a powder or liquid coating cycle, available for all metal door components.
- The marine Silver and Metropolitan finishes, being made by anodic oxidation can be realized only for aluminum components. **Not possible for handles.**

## FINISHES FOR HARDWARE



## FINISH MATERIAL

- **VP** - Powder Coating
- **VL** - Liquid Paining
- **OA** -Anodic Oxidation

- Available colors and finishes realized through a powder or liquid coating cycle, available for all metal door components.
- The marine Silver and Metropolitan finishes, being made by anodic oxidation can be realized only for aluminum components.

